

# WY-100V

NAKAMURA-TOME  
PRECISION INDUSTRY CO.,LTD.

Faster than  
the fastest

Innovative  
Technology

~Creating new values~

# WY-100V

The first of the "V series" multitasking machines, with speed as the design concept behind it.  
Y-axis on the upper/lower turret and opposed twin spindles are standard equipment.  
Enhanced processing capabilities and simultaneous left/right and upper/lower machining reinforce speedy production.  
Furthermore, we have made software improvements to reduce idle time. It strives to be faster than the fastest that customers have ever experienced.

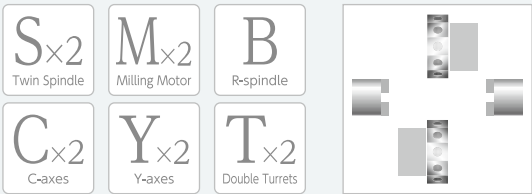

## 30% Reduction in Cycle Time

Starting with the implementation of "ChronoCut" to reduce processing idle time, numerous new technologies have been incorporated to enhance production speed.



### Hydraulic valve component (sample)

Material	S45C
Material Size	φ51mm×L75mm

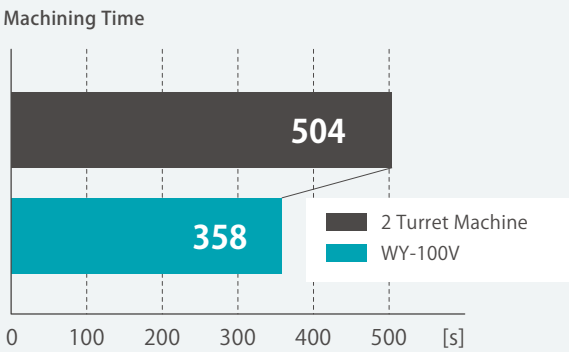

### ChronoCut

A unique function by Nakamura-Tome designed to reduce idle time. This new software minimizes idle time during manufacturing without compromising accuracy, even without any changes to the cutting conditions.

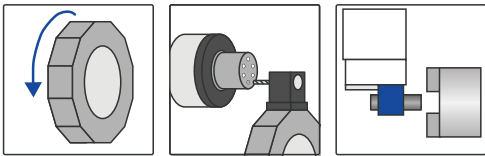

- High-speed indexing
- High-speed spindle synchronization
- Execution of multiple M-codes within the same block
- High-speed rigid tapping
- Reduction of PC-G unloading time, etc.

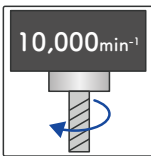

#### UP Machining conditions

By improving the machining capabilities of the milling speed, torque, and more, the machine achieves high performance under demanding conditions.

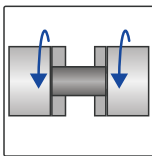

#### UP Acceleration / Deceleration

The acceleration and deceleration during starting and stopping have been improved, enabling quick attainment to the maximum speed.

Cycle Times are Faster Thanks to Simultaneous Machining with the L/R Spindles and Upper/Lower Turrets.

L-spindle

Standard	
Bar capacity	φ42mm
Spindle speed	6,000min <sup>-1</sup>
Spindle motor	11/7.5kW
Option	
Bar capacity	φ51mm
Spindle speed	6,000min <sup>-1</sup>
Option	
Spindle motor	11/7.5kW
Option	
Bar capacity	φ65mm
Spindle speed	5,000min <sup>-1</sup>
Option	
Spindle motor	11/7.5kW
Option	
Spindle motor	15/11kW

Upper turret

Standard		Option	
Milling speed	6,000min <sup>-1</sup>	Milling speed	10,000min <sup>-1</sup>
Milling motor	7.1/2.2kW	Milling motor	7.5/2.2kW
Dodecagonal drum turret		15-station turret	
Y-axis slide travel	±42mm	Y-axis slide travel	±31mm
Number of milling stations / Number of indexing positions	12 / 24	Number of milling stations / Number of indexing positions	15 / 15

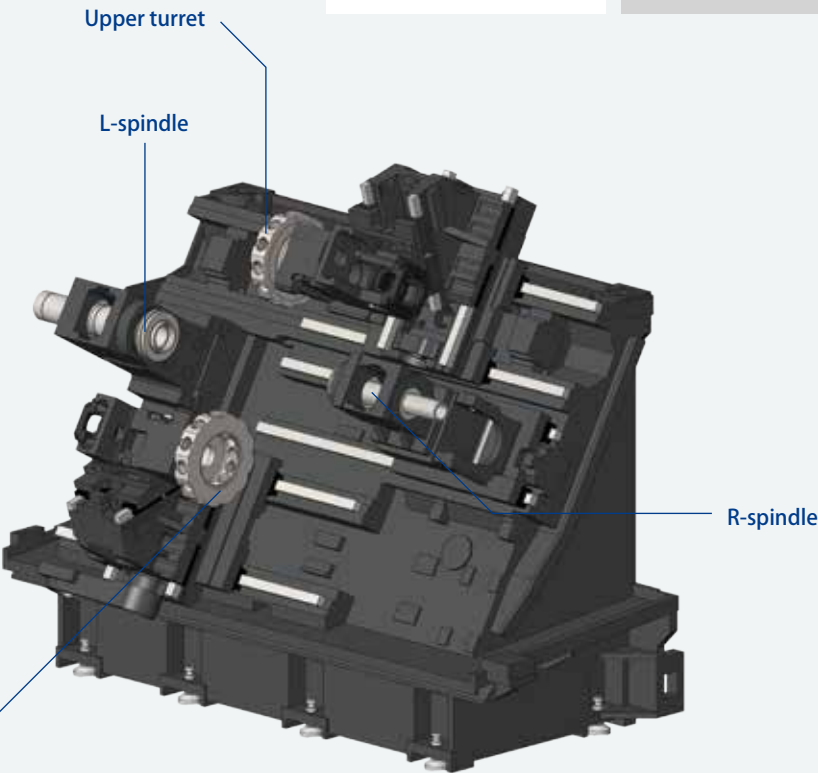

Lower turret

Standard		Option	
Milling speed	6,000min <sup>-1</sup>	Milling speed	10,000min <sup>-1</sup>
Milling motor	7.1/2.2kW	Milling motor	7.5/2.2kW
Dodecagonal drum turret		15-station turret	
Y-axis slide travel	±32.5mm	Y-axis slide travel	±31mm
Number of milling stations / Number of indexing positions	12 / 24	Number of milling stations / Number of indexing positions	15 / 15

Y-axis and Milling are standard.



R-spindle

Standard		Option	
Bar capacity	φ42mm	Bar capacity	φ51mm
Spindle speed	6,000min <sup>-1</sup>	Spindle speed	6,000min <sup>-1</sup>
Spindle motor	11/7.5kW	Spindle motor	11/7.5kW
Option		Option	
Spindle motor	11/7.5kW	Spindle motor	15/11kW

GR-203 High-Speed(op.)

The entire process from loading the blank material, to unloading a finished part, can be automated.  
\* The image is of NTY<sup>3</sup>-100.



Compact Loader(op.)

The entire process from loading the blank material, to unloading a finished part, can be automated.

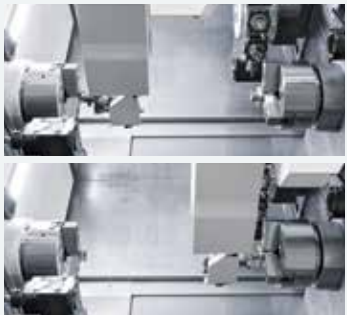

Parts catcher type G(op.)

Unloading a finished part can be automated.



NT SmartX  
19 inch touch screen

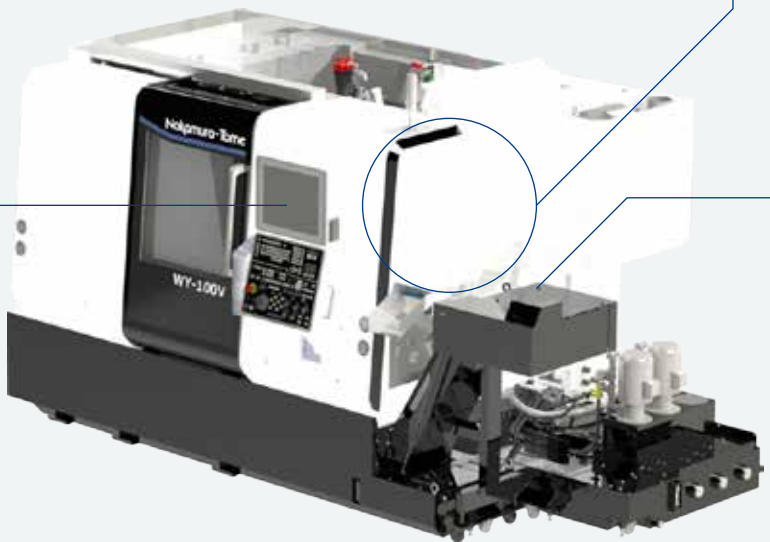

Chip conveyor(op.)

The discharge position can be selected from the following three options.  
• Side  
• Right side & Rear  
• Left side & Rear

Turning

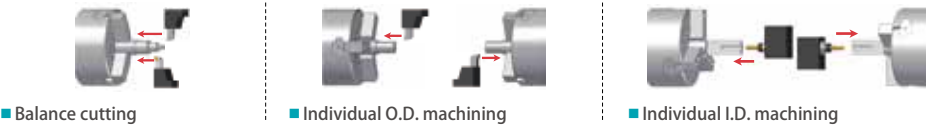

Milling

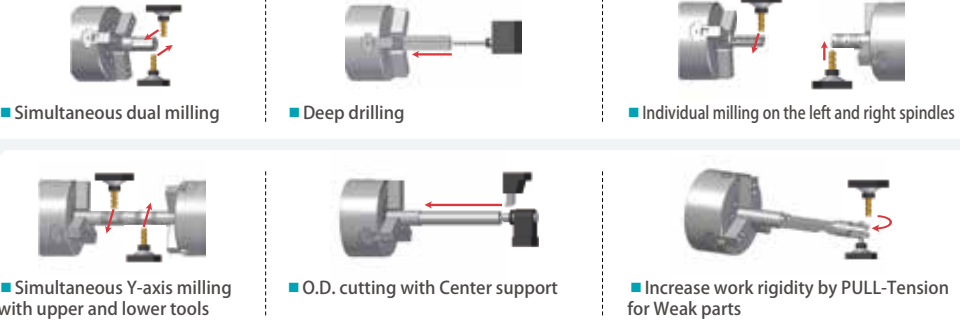

Eco Friendly

Addition of ECO mode functions to NT SmartX

- Monitor OFF-TIMER <min>
- Machine Light OFF-TIMER <min>
- Servo Power Supply OFF-TIMER <min>
- Motor acc./dec. output limitation <%>

Improvement of the power control system

- The fan motor stops except during auto operation
- Grease lubrication for all axes
- Inverter-controlled hydraulic unit
- Dry brake
- Regenerative energy





<https://www.nakamura-tome.com/>

Netsuno 15, Hakusan city, Ishikawa, 920-2195 Japan  
Phone : +81 76 273 8100 Fax : +81 76 273 4312  
E-mail : nt-jpn@nakamura-tome.co.jp

- \* This catalog was published in June 2023. Specifications, illustrations and data given herein are subject to change without notice.
- \* The products in this catalog are controlled by Japan's "Foreign Exchange and Foreign Trade Law". The export of the products is subject to an export license to be issued by the Japanese government.